



Vent System for Category II, III, IV Gas Fired Appliances



SECURITY CHIMNEYS
INTERNATIONAL™

CTX

Secure Seal™ Gas Vent



CTX Secure Seal™

CTX applications

The CTX Secure Seal™ venting system is the answer to most modern venting needs.

- Category II, III and IV gas-fired appliances
- Type BH gas vent systems for appliances having a maximum flue temperature of 480° F
- May also be used for high-efficiency gas boilers, furnaces, booster heaters, pool heaters, water heaters, unit heaters or tankless water heaters
- Installs quickly and easily with self-sealing Secure Seal gaskets and built-in mechanical gear clamps



A tradition of excellence

For over 30 years, Security Chimneys™ has been an innovator in the venting field and a market leader in North America. Instrumental in the company's growth has been an ongoing focus on product improvement and the introduction of new, innovative products. This drive for excellence has given rise to the CTX Secure Seal venting system, a line of high-quality products that deliver optimal performance.



CTX – Vertical installation through the roof

Quality and dependability

The CTX venting system is manufactured from AL29-4C^{®*}, a super-ferritic stainless steel designed for extreme resistance to chloride ion pitting, crevice corrosion and stress corrosion cracking, as well as general corrosion in oxidizing and moderately reducing environments. AL29-4C is the ideal choice for withstanding the harmful effects of corrosive condensates created by partially or fully condensing high-efficiency natural gas and propane-fired heating appliances.

The Canadian Gas Research Institute found that test results proved AL29-4C to be one of the two “most corrosion-resistant alloys of 20 candidate stainless steels evaluated for resistance to chloride-induced corrosion in condensing and partially condensing gas-fired appliances.” AL29-4C is patented and manufactured by Allegheny Ludlum Corporation.

CTX has been tested and is listed by Underwriters Laboratories, Inc. to UL 1738 and CAN/ULCS636.

Built to last

CTX features a smooth weld seam inside and out, which is completely shielded during the TIG welding process. Contamination or molecular changes in the weld seam are avoided and no fillers are used in the welding process.

To guarantee a perfect fit every time and to avoid built-in stress points or weak areas, tube ends are formed under the stringent guidelines and held to exacting standards.

Feature	Benefit
Laser butt-welding	<ul style="list-style-type: none">• Reinforces strength• Prevents leakage• Increased durability and reliability
Built-in mechanical gear clamps	<ul style="list-style-type: none">• Provide quick and easy assembly and disassembly• Requires less time on the job site
Secure Seal™ sealing gaskets	<ul style="list-style-type: none">• Self-sealing, so there's no need to apply sealing material when pieces are joined together• Easier and faster installation
Wall thimble with built-in adjustable vent length	<ul style="list-style-type: none">• Provides horizontal adjustability with no requirement to cut the pipe
Standard adjustable vent length	<ul style="list-style-type: none">• Provides vertical or horizontal adjustment for easy system pitching
AL29-4C [®] stainless steel	<ul style="list-style-type: none">• Resists the extreme corrosive environments found in condensing boilers• Assures safe and trouble-free operation
Proven track record	<ul style="list-style-type: none">• Tested and listed by Underwriters Laboratories, Inc. to UL 1738 & ULC-S636• 15-year warranty

*AL29-4C[®] is a registered trademark of Allegheny Ludlum Corporation.

CTX Secure Seal™

Installation made easy

Each CTX vent length and component features a built-in mechanical locking band and gasket. Parts are easily pushed together to a stop bead, which causes the joints to become air- and water-tight. By tightening the integrated mechanical locking band, parts are fastened together instantly and effortlessly. CTX can be taken apart and easily reassembled, making inspection, maintenance or rerouting of CTX systems simple and straightforward. If a component or gasket becomes damaged, replacement takes less than five minutes without harming the integrity of the system.



Adjustable vent lengths featured in wall thimbles allow for built-in horizontal adjustability without the need for cutting pipe. A standard adjustable vent length allows 2" to 12" of adjustment, simplifying pitching of the CTX to properly drain condensate. Connecting the CTX to a heater is effortless with one of the many adaptors approved by heating appliance manufacturers. Heating equipment can be operated immediately upon completing a CTX installation, as no cure time or cleanup is required.

Clearance to Combustibles

Rated Operating Temperature		Enclosed		Unenclosed	
		Horizontal	Vertical	Horizontal	Vertical
3" & 4"	300° F 149° C	Sides: 8" / 203.2mm Top: 12" / 304.8mm Bottom: 4" / 101.6mm	4" 101.6mm	1" 25.4mm	1" 25.4mm
	480° F 249° C		4" 101.6mm	3" 76.2mm	1" 25.4mm
5" to 16"	300° F 149° C	Noncombustible enclosure		3" 76.2mm	3" 76.2mm
	480° F 249° C			3" 76.2mm	3" 76.2mm

Rated Operating Temperature of 300° F = Max Flue Gas Temperature of 375° F
 Rated Operating Temperature of 480° F = Max Flue Gas Temperature of 550° F

Material Thickness AL29-4C®*

3"-7" (76.2mm-177.8mm)	.016" (.4mm)
8"-12" (203.2mm-304.8mm)	.019" (.5mm)
14"-16" (355.6mm-406.4mm)	.024" (.6mm)

*AL29-4C® is a registered trademark of Allegheny Ludlum Corporation.

Venting Lengths



CTX Vent Lengths

A (in.)	B (in.)	C (in.)	Product Code
3.00	34.00	36.00	CTX3L36
3.00	22.00	24.00	CTX3L24
3.00	16.00	18.00	CTX3L18
3.00	10.00	12.00	CTX3L12
3.00	4.00	6.00	CTX3L6
4.00	34.00	36.00	CTX4L36
4.00	22.00	24.00	CTX4L24
4.00	16.00	18.00	CTX4L18
4.00	10.00	12.00	CTX4L12
4.00	4.00	6.00	CTX4L6
5.00	34.00	36.00	CTX5L36
5.00	22.00	24.00	CTX5L24
5.00	16.00	18.00	CTX5L18
5.00	10.00	12.00	CTX5L12
5.00	4.00	6.00	CTX5L6
6.00	34.00	36.00	CTX6L36
6.00	22.00	24.00	CTX6L24
6.00	16.00	18.00	CTX6L18
6.00	10.00	12.00	CTX6L12
6.00	4.00	6.00	CTX6L6
7.00	34.00	36.00	CTX7L36
7.00	22.00	24.00	CTX7L24
7.00	16.00	18.00	CTX7L18
7.00	10.00	12.00	CTX7L12
7.00	4.00	6.00	CTX7L6
8.00	34.00	36.00	CTX8L36
8.00	22.00	24.00	CTX8L24
8.00	16.00	18.00	CTX8L18
8.00	10.00	12.00	CTX8L12
8.00	4.00	6.00	CTX8L6
9.00	34.00	36.00	CTX9L36
9.00	22.00	24.00	CTX9L24
9.00	16.00	18.00	CTX9L18
9.00	10.00	12.00	CTX9L12
9.00	4.00	6.00	CTX9L6
10.00	34.00	36.00	CTX10L36
10.00	22.00	24.00	CTX10L24
10.00	16.00	18.00	CTX10L18
10.00	10.00	12.00	CTX10L12
10.00	4.00	6.00	CTX10L6
12.00	34.00	36.00	CTX12L36
12.00	22.00	24.00	CTX12L24
12.00	16.00	18.00	CTX12L18
12.00	10.00	12.00	CTX12L12
12.00	4.00	6.00	CTX12L6
14.00	34.00	36.00	CTX14L36
14.00	22.00	24.00	CTX14L24
14.00	16.00	18.00	CTX14L18
14.00	10.00	12.00	CTX14L12
14.00	4.00	6.00	CTX14L6
16.00	34.00	36.00	CTX16L36
16.00	22.00	24.00	CTX16L24
16.00	16.00	18.00	CTX16L18
16.00	10.00	12.00	CTX16L12
16.00	4.00	6.00	CTX16L6

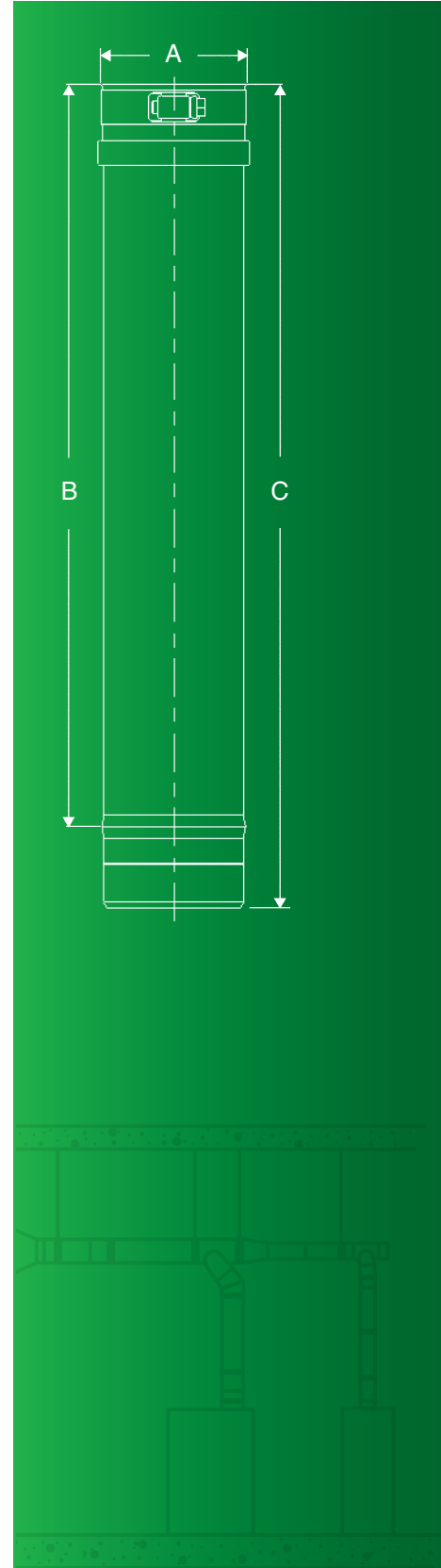

Venting Lengths

CTX Adjustable Vent Lengths

A (in.)	B (in.)	C (in.)	D (in.)	Product Code
3.00	2.0-14.0	18.00	N/A	CTX3LA
4.00	2.0-14.0	18.00	N/A	CTX4LA
5.00	2.0-14.0	18.00	N/A	CTX5LA
6.00	2.0-14.0	18.00	N/A	CTX6LA
7.00	2.0-14.0	18.00	N/A	CTX7LA
8.00	2.0-14.0	18.00	N/A	CTX8LA
9.00	2.0-14.0	18.00	N/A	CTX9LA
10.00	2.0-14.0	18.00	N/A	CTX10LA
12.00	2.0-14.0	18.00	N/A	CTX12LA
14.00	2.0-14.0	18.00	N/A	CTX14LA
16.00	2.0-14.0	18.00	N/A	CTX16LA



CTX Test Port Lengths

A (in.)	B (in.)	C (in.)	D (in.)	Product Code
3.00	9.75	0.50	N/A	CTX3TPL
4.00	9.75	0.50	N/A	CTX4TPL
5.00	9.75	0.50	N/A	CTX5TPL
6.00	9.75	0.50	N/A	CTX6TPL
7.00	9.75	0.50	N/A	CTX7TPL
8.00	9.75	0.50	N/A	CTX8TPL
9.00	9.75	0.50	N/A	CTX9TPL
10.00	9.75	0.50	N/A	CTX10TPL
12.00	9.75	0.50	N/A	CTX12TPL
14.00	9.75	0.50	N/A	CTX14TPL
16.00	9.75	0.50	N/A	CTX16TPL



CTX Drain Lengths

A (in.)	B (in.)	C (in.)	D (in.)	Product Code
4.00	6.40	8.40	0.63	CTX4DL12
5.00	6.40	8.40	0.63	CTX5DL12
6.00	6.40	8.40	0.63	CTX6DL12
7.00	6.40	8.40	0.63	CTX7DL12
8.00	6.40	8.40	0.63	CTX8DL12
9.00	6.40	8.40	0.63	CTX9DL12
10.00	6.40	8.40	0.63	CTX10DL12
12.00	6.40	8.40	0.63	CTX12DL12
14.00	6.40	8.40	0.63	CTX14DL12
16.00	6.40	8.40	0.63	CTX16DL12

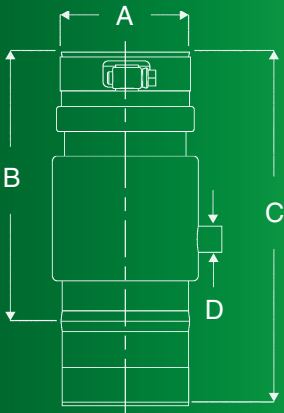
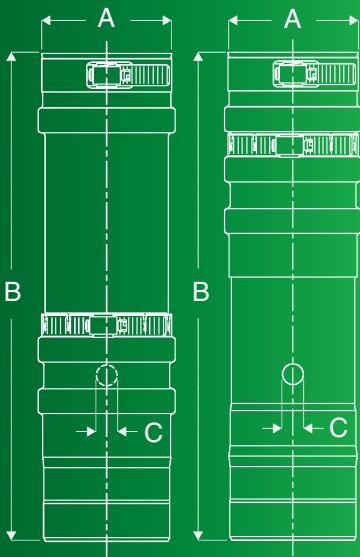
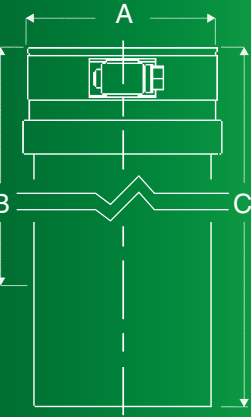

Venting Elbows

CTX 30-Degree Elbows



A (in.)	B (in.)	C (in.)	D (in.)	Product Code
3.00	4.90	1.80	N/A	CTX3E30
4.00	5.20	1.90	N/A	CTX4E30
5.00	5.40	2.00	N/A	CTX5E30
6.00	5.70	2.00	N/A	CTX6E30
7.00	5.90	2.10	N/A	CTX7E30
8.00	6.10	2.20	N/A	CTX8E30
9.00	6.40	2.20	N/A	CTX9E30
10.00	6.70	2.30	N/A	CTX10E30
12.00	7.20	2.40	N/A	CTX12E30
14.00	7.70	2.60	N/A	CTX14E30
16.00	8.20	2.70	N/A	CTX16E30

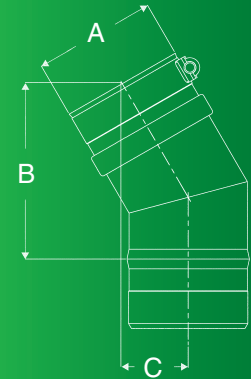

CTX 45-Degree Elbows



A (in.)	B (in.)	C (in.)	D (in.)	Product Code
3.00	5.20	3.00	N/A	CTX3E45
4.00	5.60	3.10	N/A	CTX4E45
5.00	6.00	3.20	N/A	CTX5E45
6.00	6.30	3.40	N/A	CTX6E45
7.00	6.70	3.50	N/A	CTX7E45
8.00	7.00	3.70	N/A	CTX8E45
9.00	7.40	3.80	N/A	CTX9E45
10.00	7.70	4.00	N/A	CTX10E45
12.00	8.40	4.30	N/A	CTX12E45
14.00	9.10	4.70	N/A	CTX14E45
16.00	9.80	4.90	N/A	CTX16E45

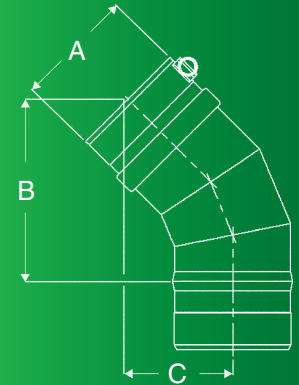

CTX 90-Degree Elbows

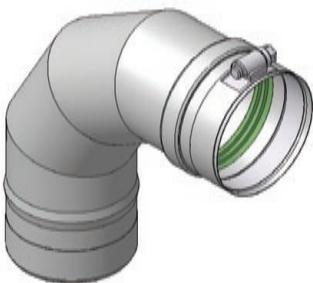

A (in.)	B (in.)	C (in.)	D (in.)	Product Code
3.00	3.90	5.90	N/A	CTX3E90
4.00	4.40	6.40	N/A	CTX4E90
5.00	4.90	6.90	N/A	CTX5E90
6.00	5.40	7.40	N/A	CTX6E90
7.00	5.90	7.90	N/A	CTX7E90
8.00	6.40	8.40	N/A	CTX8E90
9.00	6.90	8.90	N/A	CTX9E90
10.00	7.40	9.40	N/A	CTX10E90
12.00	8.40	10.40	N/A	CTX12E90
14.00	9.40	11.40	N/A	CTX14E90
16.00	10.10	12.40	N/A	CTX16E90

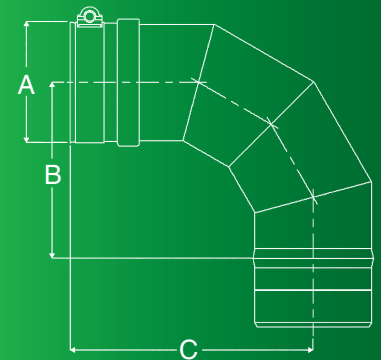

Venting Tees

CTX Tees

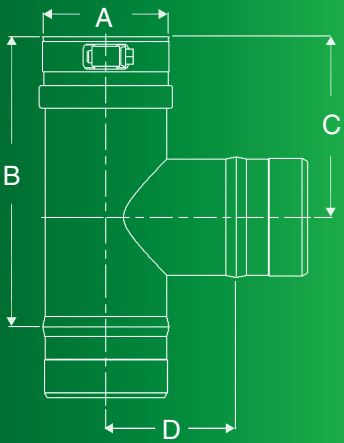

A (in.)	B (in.)	C (in.)	D (in.)	Product Code
3.00	7.00	4.50	3.00	CTX3T
4.00	8.00	5.00	3.50	CTX4T
5.00	10.00	6.00	4.00	CTX5T
6.00	10.00	6.00	4.50	CTX6T
7.00	12.00	7.00	5.00	CTX7T
8.00	14.00	8.00	5.50	CTX8T
9.00	14.00	8.00	6.00	CTX9T
10.00	14.00	8.00	6.50	CTX10T
12.00	16.00	9.00	7.00	CTX12T
14.00	20.00	11.00	8.50	CTX14T
16.00	22.00	12.00	9.50	CTX16T



CTX Tee Caps

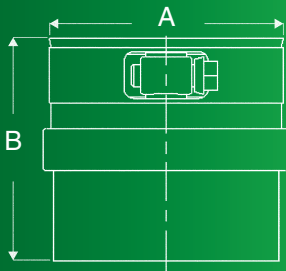

A (in.)	B (in.)	C (in.)	D (in.)	Product Code
3.00	3.00	N/A	N/A	CTX3TC
4.00	3.00	N/A	N/A	CTX4TC
5.00	3.00	N/A	N/A	CTX5TC
6.00	3.00	N/A	N/A	CTX6TC
7.00	3.00	N/A	N/A	CTX7TC
8.00	3.00	N/A	N/A	CTX8TC
9.00	3.00	N/A	N/A	CTX9TC
10.00	3.00	N/A	N/A	CTX10TC
12.00	3.00	N/A	N/A	CTX12TC
14.00	3.00	N/A	N/A	CTX14TC
16.00	3.00	N/A	N/A	CTX16TC



CTX Drain Tee Caps

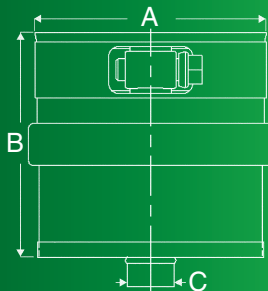

A (in.)	B (in.)	C (in.)	D (in.)	Product Code
3.00	3.00	0.63	N/A	CTX3DTC
4.00	3.00	0.63	N/A	CTX4DTC
5.00	3.00	0.63	N/A	CTX5DTC
6.00	3.00	0.63	N/A	CTX6DTC
7.00	3.00	0.63	N/A	CTX7DTC
8.00	3.00	0.63	N/A	CTX8DTC
9.00	3.00	0.63	N/A	CTX9DTC
10.00	3.00	0.63	N/A	CTX10DTC
12.00	3.00	0.63	N/A	CTX12DTC
14.00	3.00	0.63	N/A	CTX14DTC
16.00	3.00	0.63	N/A	CTX16DTC



Venting Tees



CTX Boot Tees

A (in.)	B (in.)	C (in.)	D (in.)	Product Code
4.00	11.50	7.50	N/A	CTX4BT
5.00	12.50	8.00	N/A	CTX5BT
6.00	13.50	8.50	N/A	CTX6BT
7.00	14.50	9.00	N/A	CTX7BT
8.00	15.50	9.50	N/A	CTX8BT
9.00	16.50	10.00	N/A	CTX9BT
10.00	17.50	10.50	N/A	CTX10BT
12.00	19.50	11.50	N/A	CTX12BT
14.00	21.50	12.50	N/A	CTX14BT
16.00	23.50	13.50	N/A	CTX16BT

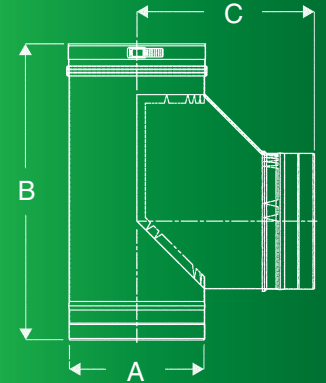

CTX Branch Tees

A (in.)	B (in.)	C (in.)	D (in.)	Product Code
4.00	8.20	3.00	3.50	CTXT4BR3
5.00	9.20	3.00	4.00	CTXT5BR3
5.00	9.20	4.00	4.00	CTXT5BR4
6.00	10.20	5.00	4.50	CTXT6BR5
8.00	12.20	4.00	5.50	CTXT8BR4
8.00	12.20	5.00	5.50	CTXT8BR5

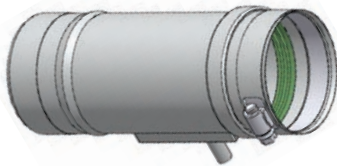
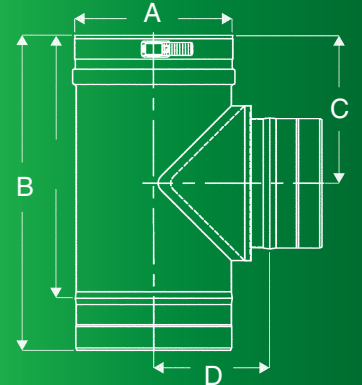

CTX Horizontal Drip Tees

A (in.)	B (in.)	C (in.)	D (in.)	Product Code
3.00	6.00	1.50	0.38	CTX3HDT
4.00	6.00	1.50	0.38	CTX4HDT

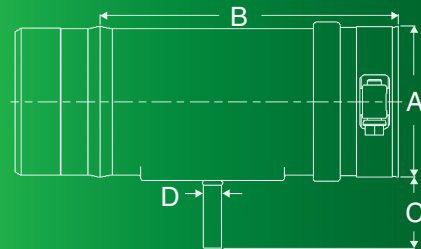

Venting Accessories

CTX Wall Radiation Shields

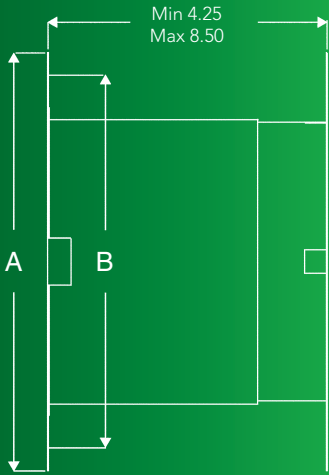

A (in.)	B (in.)	C (in.)	D (in.)	Product Code
9.00	12.00	N/A	N/A	CTX3WRS
10.00	13.00	N/A	N/A	CTX4WRS
11.00	14.00	N/A	N/A	CTX5WRS
12.00	15.00	N/A	N/A	CTX6WRS
13.00	16.00	N/A	N/A	CTX7WRS
14.00	17.00	N/A	N/A	CTX8WRS
15.00	18.00	N/A	N/A	CTX9WRS
16.00	19.00	N/A	N/A	CTX10WRS
18.00	21.00	N/A	N/A	CTX12WRS
20.00	23.00	N/A	N/A	CTX14WRS
22.00	25.00	N/A	N/A	CTX16WRS



CTX Wall Radiation Shield Extensions

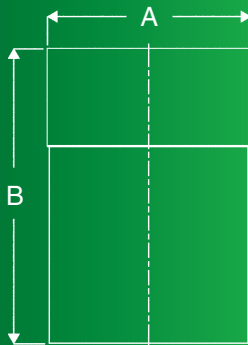

A (in.)	B (in.)	C (in.)	D (in.)	Product Code
6.00	9.00	N/A	N/A	CTX3WRE
7.00	10.00	N/A	N/A	CTX4WRE
8.00	11.00	N/A	N/A	CTX5WRE
9.00	12.00	N/A	N/A	CTX6WRE
10.00	13.00	N/A	N/A	CTX7WRE
11.00	14.00	N/A	N/A	CTX8WRE
12.00	15.00	N/A	N/A	CTX9WRE
13.00	16.00	N/A	N/A	CTX10WRE
15.00	18.00	N/A	N/A	CTX12WRE
17.00	20.00	N/A	N/A	CTX14WRE
19.00	22.00	N/A	N/A	CTX16WRE

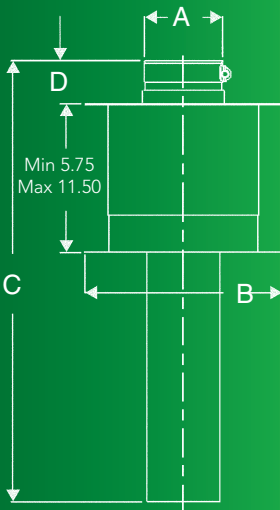

CTX Wall Radiation Shield W/Adj. Length

A (in.)	B (in.)	C (in.)	D (in.)	Product Code
3.00	9.00	18.00	2.00	CTX3WRSAL
4.00	10.00	18.00	2.00	CTX4WRSAL
5.00	11.00	18.00	2.00	CTX5WRSAL
6.00	12.00	18.00	2.00	CTX6WRSAL
7.00	13.00	18.00	2.00	CTX7WRSAL
8.00	14.00	18.00	2.00	CTX8WRSAL
9.00	15.00	18.00	2.00	CTX9WRSAL
10.00	16.00	18.00	2.00	CTX10WRSAL
12.00	18.00	18.00	2.00	CTX12WRSAL
14.00	20.00	18.00	2.00	CTX14WRSAL
16.00	22.00	18.00	2.00	CTX16WRSAL



Venting Accessories

CTX Firestop/Support Plates



A (in.)	B (in.)	C (in.)	D (in.)	Product Code
3.04	15.00	N/A	N/A	CTX3FSSP
4.04	15.00	N/A	N/A	CTX4FSSP
5.04	17.00	N/A	N/A	CTX5FSSP
6.04	17.00	N/A	N/A	CTX6FSSP
7.04	19.00	N/A	N/A	CTX7FSSP
8.04	19.00	N/A	N/A	CTX8FSSP
9.04	22.00	N/A	N/A	CTX9FSSP
10.04	22.00	N/A	N/A	CTX10FSSP
12.04	24.00	N/A	N/A	CTX12FSSP
14.04	26.00	N/A	N/A	CTX14FSSP
16.04	28.00	N/A	N/A	CTX16FSSP

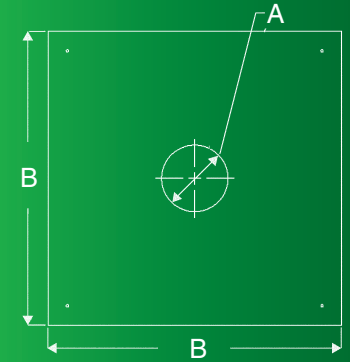

CTX Support Clamps



A (in.)	B (in.)	C (in.)	D (in.)	Product Code
3.00	1.50	N/A	N/A	CTX3SC
4.00	1.50	N/A	N/A	CTX4SC
5.00	1.50	N/A	N/A	CTX5SC
6.00	1.50	N/A	N/A	CTX6SC
7.00	1.50	N/A	N/A	CTX7SC
8.00	1.50	N/A	N/A	CTX8SC
9.00	1.50	N/A	N/A	CTX9SC
10.00	1.50	N/A	N/A	CTX10SC
12.00	1.50	N/A	N/A	CTX12SC
14.00	1.50	N/A	N/A	CTX14SC
16.00	1.50	N/A	N/A	CTX16SC

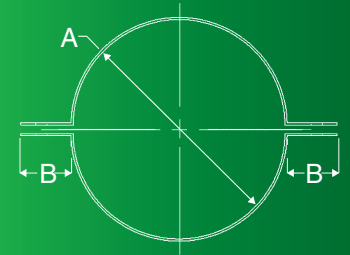

CTX Wall Supports



A (in.)	B (in.)	C (in.)	D (in.)	Product Code
3.00	3.50	N/A	N/A	CTX3WS
4.00	4.00	N/A	N/A	CTX4WS
5.00	4.50	N/A	N/A	CTX5WS
6.00	5.00	N/A	N/A	CTX6WS
7.00	5.50	N/A	N/A	CTX7WS
8.00	6.00	N/A	N/A	CTX8WS
9.00	6.50	N/A	N/A	CTX9WS
10.00	7.00	N/A	N/A	CTX10WS
12.00	8.00	N/A	N/A	CTX12WS
14.00	9.00	N/A	N/A	CTX14WS
16.00	10.00	N/A	N/A	CTX16WS

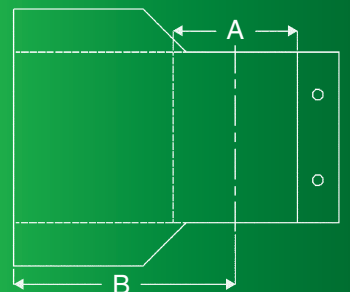

Venting Accessories

CTX Universal Flue Adaptor

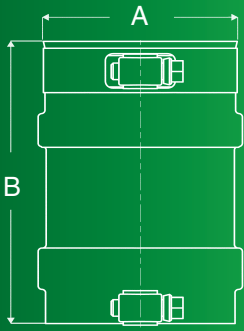

A (in.)	B (in.)	C (in.)	D (in.)	Product Code
3.00	5.30	N/A	N/A	CTX3UA
4.00	5.30	N/A	N/A	CTX4UA
5.00	5.30	N/A	N/A	CTX5UA
6.00	5.30	N/A	N/A	CTX6UA
7.00	5.30	N/A	N/A	CTX7UA
8.00	5.30	N/A	N/A	CTX8UA
9.00	5.30	N/A	N/A	CTX9UA
10.00	5.30	N/A	N/A	CTX10UA
12.00	5.30	N/A	N/A	CTX12UA
14.00	5.30	N/A	N/A	CTX14UA
16.00	5.30	N/A	N/A	CTX16UA



CTX Universal Test Port Adaptor

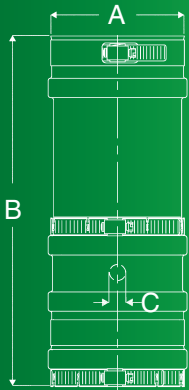

A (in.)	B (in.)	C (in.)	D (in.)	Product Code
3.00	10.88	0.50	N/A	CT3UTPA
4.00	10.88	0.50	N/A	CT4UTPA
5.00	10.88	0.50	N/A	CT5UTPA
6.00	10.88	0.50	N/A	CT6UTPA
7.00	10.88	0.50	N/A	CT7UTPA
8.00	10.88	0.50	N/A	CT8UTPA
9.00	10.88	0.50	N/A	CT9UTPA
10.00	10.88	0.50	N/A	CT10UTPA
12.00	10.88	0.50	N/A	CT12UTPA
14.00	10.88	0.50	N/A	CT14UTPA
16.00	10.88	0.50	N/A	CT16UTPA



CTX Adaptor Increaser

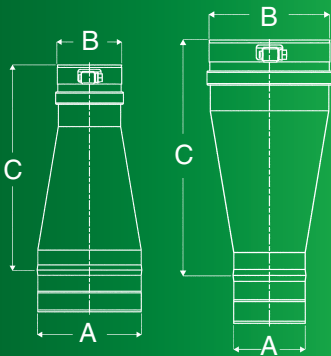

A (in.)	B (in.)	C (in.)	D (in.)	Product Code
3.00	4.00	6.90	N/A	CTX3IA4

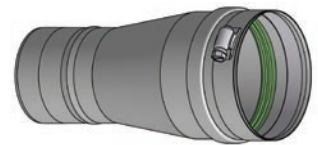

CTX Adaptor Reducer

A (in.)	B (in.)	C (in.)	D (in.)	Product Code
4.00	3.00	6.90	N/A	CTX4RA3

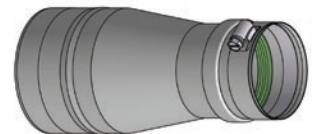

CTX Adjustable Roof Flashing

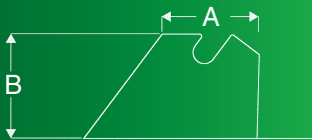

A (in.)	B (in.)	C (in.)	D (in.)	Product Code
5.00	7.00	N/A	N/A	CTX3FA
6.00	7.00	N/A	N/A	CTX4FA
7.00	7.00	N/A	N/A	CTX5FA
8.00	7.00	N/A	N/A	CTX6FA
9.00	7.00	N/A	N/A	CTX7FA
10.00	7.00	N/A	N/A	CTX8FA
11.00	7.00	N/A	N/A	CTX9FA
12.00	7.00	N/A	N/A	CTX10FA
14.00	7.00	N/A	N/A	CTX12FA
16.00	7.00	N/A	N/A	CTX14FA
18.00	7.00	N/A	N/A	CTX16FA

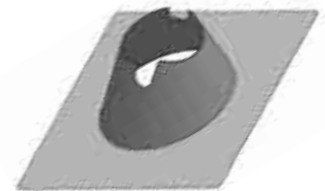

Venting Accessories



CTX Roof Radiation Shields

A (in.)	B (in.)	C (in.)	D (in.)	Product Code
4.00	18.00	N/A	N/A	CTX3RRS
5.00	18.00	N/A	N/A	CTX4RRS
6.00	18.00	N/A	N/A	CTX5RRS
7.00	18.00	N/A	N/A	CTX6RRS
8.00	18.00	N/A	N/A	CTX7RRS
9.00	18.00	N/A	N/A	CTX8RRS
10.00	18.00	N/A	N/A	CTX9RRS
11.00	18.00	N/A	N/A	CTX10RRS
13.00	18.00	N/A	N/A	CTX12RRS
15.00	18.00	N/A	N/A	CTX14RRS
17.00	18.00	N/A	N/A	CTX16RRS

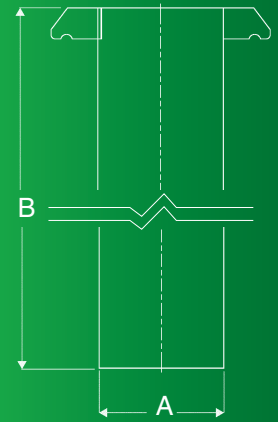

CTX Flashing Collars

A (in.)	B (in.)	C (in.)	D (in.)	Product Code
3.00	N/A	N/A	N/A	CTX3FC
4.00	N/A	N/A	N/A	CTX4FC
5.00	N/A	N/A	N/A	CTX5FC
6.00	N/A	N/A	N/A	CTX6FC
7.00	N/A	N/A	N/A	CTX7FC
8.00	N/A	N/A	N/A	CTX8FC
9.00	N/A	N/A	N/A	CTX9FC
10.00	N/A	N/A	N/A	CTX10FC
12.00	N/A	N/A	N/A	CTX12FC
14.00	N/A	N/A	N/A	CTX14FC
16.00	N/A	N/A	N/A	CTX16FC

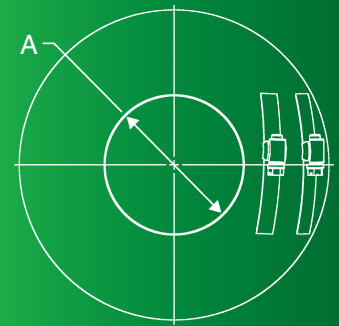

Venting Terminations



CTX Rain Caps

A (in.)	B (in.)	C (in.)	D (in.)	Product Code
3.00	3.50	6.80	1.00	CTX3RC
4.00	4.50	8.90	1.00	CTX4RC
5.00	5.80	11.30	1.00	CTX5RC
6.00	6.80	13.50	1.00	CTX6RC
7.00	7.80	15.80	1.00	CTX7RC
8.00	8.80	18.00	1.00	CTX8RC
9.00	10.00	20.30	1.00	CTX9RC
10.00	11.00	22.50	1.00	CTX10RC
12.00	13.00	27.00	1.00	CTX12RC
14.00	15.00	31.50	1.00	CTX14RC
16.00	17.00	36.00	1.00	CTX16RC

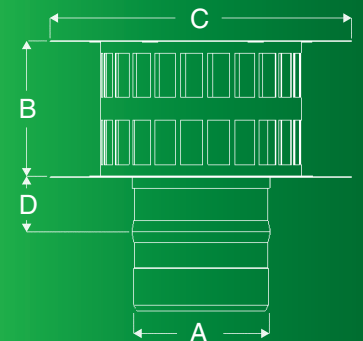

Venting Terminations

CTX Termination Tees

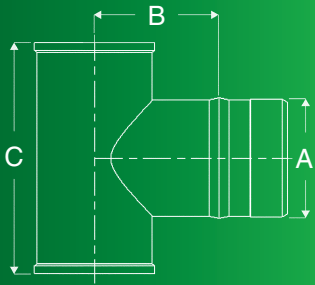

A (in.)	B (in.)	C (in.)	D (in.)	Product Code
3.00	3.00	6.00	N/A	CTX3TT
4.00	3.50	7.00	N/A	CTX4TT
5.00	4.00	8.00	N/A	CTX5TT
6.00	4.50	9.00	N/A	CTX6TT



CTX Termination Boxes

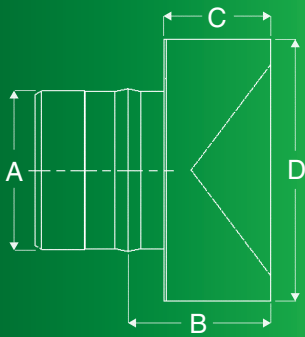

A (in.)	B (in.)	C (in.)	D (in.)	Product Code
3.00	2.30	2.00	5.00	CTX3SQT
4.00	2.30	2.00	6.00	CTX4SQT



CTX Horizontal Terminations

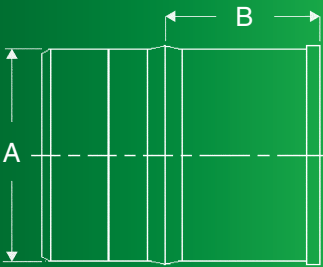

A (in.)	B (in.)	C (in.)	D (in.)	Product Code
3.00	2.00	N/A	N/A	CTX3HT
4.00	2.00	N/A	N/A	CTX4HT



CTX Angled Horizontal Terminations

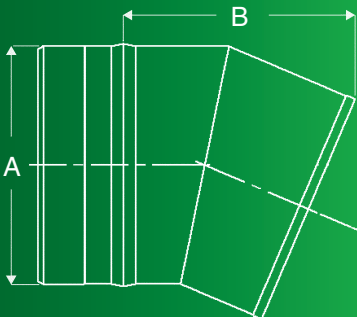

A (in.)	B (in.)	C (in.)	D (in.)	Product Code
5.00	4.80	N/A	N/A	CTX5AHT
6.00	5.60	N/A	N/A	CTX6AHT
7.00	6.40	N/A	N/A	CTX7AHT
8.00	7.10	N/A	N/A	CTX8AHT
9.00	7.90	N/A	N/A	CTX9AHT
10.00	8.70	N/A	N/A	CTX10AHT
12.00	10.20	N/A	N/A	CTX12AHT
14.00	11.70	N/A	N/A	CTX14AHT
16.00	13.20	N/A	N/A	CTX16AHT



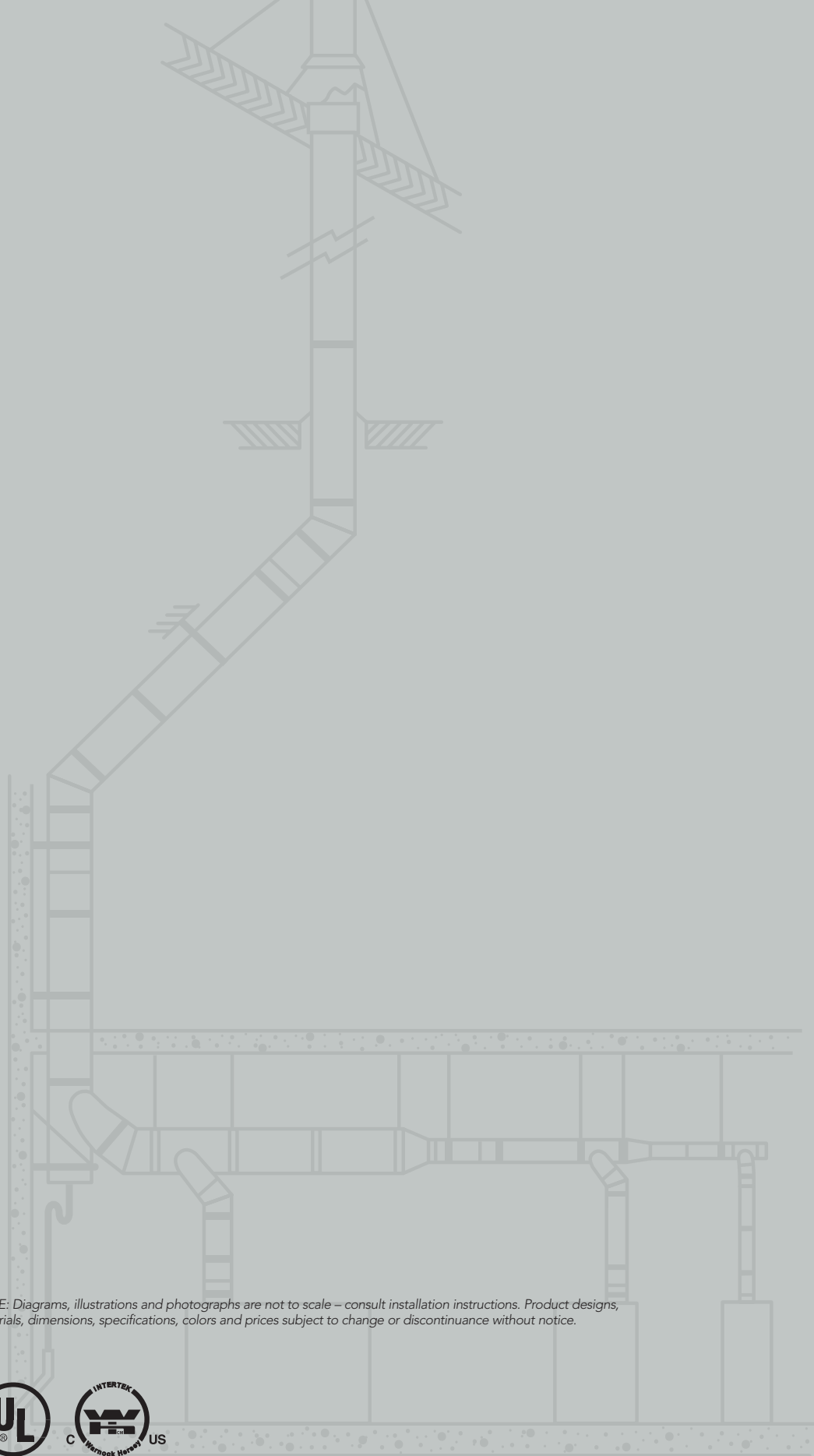

NOTE: Diagrams, illustrations and photographs are not to scale – consult installation instructions. Product designs, materials, dimensions, specifications, colors and prices subject to change or discontinuance without notice.



2125 Monterey, Laval, Quebec, Canada
H7L 3T6

Phone: 450-973-9999

Fax: 450-687-9569

www.securitychimneys.com

ACTX 06/07

© Lennox Industries Inc. 2007

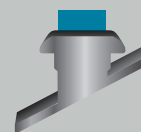

**SECURITY CHIMNEYS
INTERNATIONAL™**