

SECURITY CHIMNEYS  
INTERNATIONAL®



# INSTALLATION INSTRUCTIONS

## Single Wall or Double Wall AL29-4C® Special Gas Vent for Category I, II, III and IV

4" to 24" Diameter Vent For use on Positive, Neutral and  
Negative Pressures up to 35" W.C.

P/N 506128-10 REV. D 01/2012

### **MODEL Secure Seal® SS/SSD**

MODEL SS



MODEL SSD



This installation manual will enable you to obtain a safe, efficient and dependable installation of this vent system. Please read and understand these instructions before beginning your installation.

Do not alter or modify the components of this chimney system under any circumstances. Any modification or alteration of the vent system or approved accessories, including but not limited to the appliance it is connected to, may void the warranty, listings and approvals of this system and could result in an unsafe and potentially dangerous installation.

- A. Examine all components for possible shipping damage prior to installation;
- B. Proper joint assembly is essential for a safe installation. Follow these instructions exactly as written: Check severeness of joints upon completion of assembly;
- C. This venting system must be free to expand and contract. This venting system must be supported in accordance with these instructions;
- D. Check for unrestricted vent movement through walls, ceilings, and roof penetrations;
- E. Different manufacturers have different joint systems and adhesives. Do not mix pipe, fittings, or joining methods from different manufacturers.

SAVE THESE INSTRUCTIONS  
FOR FUTURE REFERENCE



Listed to standards:  
UL-1738  
ULC-S636  
Report # G100215896MTL-006

### **! WARNINGS**

**FAILURE TO FOLLOW THESE INSTALLATION INSTRUCTIONS COULD CAUSE FIRE, CARBON MONOXIDE POISONING, OR DEATH. IF YOU ARE UNSURE OF INSTALLATION REQUIREMENTS, CALL THE PHONE NUMBER LISTED ON THE BACK OF THESE INSTRUCTIONS.**

**A MAJOR CAUSE OF CHIMNEY RELATED FIRE IS FAILURE TO MAINTAIN REQUIRED CLEARANCES (AIR SPACES) TO COMBUSTIBLE MATERIALS. IT IS OF UTMOST IMPORTANCE THAT THIS VENT SYSTEM BE INSTALLED ONLY IN ACCORDANCE WITH THESE INSTRUCTIONS.**

## TABLE OF CONTENTS

Introduction .....	page 2
Testing / listing information .....	page 2
Clearances to combustibles .....	page 3
General installation requirements .....	page 3
Typical installations .....	page 4-5
Chimney and fitting joint assembly .....	page 6
Chimney weight .....	page 6
Support methods and height .....	page 7
Horizontal installation requirements .....	page 8
Maintain proper slope .....	page 8
Vertical installation requirements .....	page 8
Wall penetration .....	page 9
Roof / floor penetration .....	page 10
Condensate drains .....	page 10
Secure Seal as a liner .....	page 11
Adjustable length .....	page 12
Maintenance instructions .....	page 12
Product reference information .....	page 14

## INTRODUCTION

Secure Seal® single wall (SS) or double wall (SSD) is a special stainless steel vent system for gas fired appliances listed as Category I, II, III, and IV or in Canada as Type BH Gas Venting as noted in ULC-636, with a maximum operating temperature of 550 Degrees F (288 Degrees C), and a maximum rated positive pressure of 35" Water Column. Secure Seal must be installed by an experienced professional familiar with the operation and maintenance of heating appliances and venting. Before installing this product, examine all components for possible shipping damage and read the complete installation manual. Failure to follow proper installation procedures, including vent pitch and improper appliance connections, may cause unsafe conditions. Security Chimneys International Limited recommends the system to be inspected once a year by a qualified service technician.

## TESTING / LISTING INFORMATION

Security Chimney International, Ltd. Secure Seal model SS and SSD venting system is listed with Intertek Testing Services (ETL) to UL/ULC standards:

### U.S.A.

- UL-1738  
Special Gas Vent for Category I, II, III  
and IV appliances



### CANADA

- ULC-S636  
Type BH Gas Vent Class I/II

This product must be installed in accordance with local building code requirements as well as National codes: USA - National Fuel Gas code ANSI-Z223.1 or NFPA Standard 54, or NFPA 211. In CANADA - CAN/CGA-B149.1 or CAN/CGA-B149.2 Propane Installation Code as applicable.

## CLEARANCES TO COMBUSTIBLES

**Table 1** shows the required MINIMUM AIRSPACE CLEARANCE TO COMBUSTIBLES. “Combustibles” include framing lumber, drywall, plywood, paneling, insulation, wiring and other building materials.

Minimum Clearance to Combustibles Single Wall SS						
Diameter	Rated operating temperature	Max. operating temperature	Enclosed (4 sides)		Unenclosed (2 sides Max.)	
			Horiz.	Vert.	Horiz.	Vert.
4" to 12"	480° F (250° C)	550° F (288° C)	N/A	N/A	2"	2"
14" to 24"	480° F (250° C)	550° F (288° C)	N/A	N/A	4"	4"
Minimum Clearance to Combustibles Double Wall SSD						
Diameter	Rated operating temperature	Max. operating temperature	Enclosed (4 sides)		Unenclosed (2 sides Max.)	
			Horiz.	Vert.	Horiz.	Vert.
4" to 12"	480° F (250° C)	550° F (288° C)	N/A	1"	1"	1"
14" to 24"	480° F (250° C)	550° F (288° C)	N/A	1"	3"	1"

**Table 1 - Minimum Clearances for Secure Seal®**

Auxiliary parts such as combination Roof Supports, Roof Thimble, Flashings and Wall Thimble outer shields are intended to be attached directly to the framing or to ceilings, floors, or walls in accordance with their respective instructions. These parts, which are installed in contact with wood or other combustibles, are designed and tested to assure that they do not overheat at points of contact.

### Notes:

1. Unenclosed requires at least two sides open.
2. Single Wall (SS) may be enclosed only in non-combustible enclosure.
3. Reduced clearances may be attained by using non-combustible enclosures.
4. Combustible Material is any material made of or surfaced with wood, compressed paper, plant fibers or other materials that are capable of being ignited or burned. Such material shall be considered combustible even though it is flame-proofed, fire-retardant treated, or plastered. (Source: NFPA 54/ANSI Z223.1)
5. Design any enclosure to permit inspection of the system.
6. Do not place insulation in any required clearance spaces surrounding the vent system unless these instructions suggest otherwise and the insulation is specified or supplied.

## GENERAL INSTALLATION REQUIREMENTS

When venting Category I, II, III, or IV appliances, Secure Seal **must** be used for the entire length of the system. Do not mix pipe, fittings, or joining methods from different manufacturers. **See the Secure Seal catalog for a complete list of parts and products.** Every vent system must be planned and installed for optimum performance and safety. The venting system must be free to expand and contract and must be supported in accordance with these instructions. (Check for unrestricted vent movement through walls, ceilings, and roof penetrations). Refer to the gas appliance manufacturer’s instructions to determine venting requirements and limitations with respect to installation and use of the appliance. **It is the responsibility of the installer to contact local building and fire officials concerning any installation restrictions and/or inspection requirements that may apply.** Permits may be required before starting an installation.

- If required by the appliance manufacturer, a Drain Tee Cap must be located as close as possible to the appliance flue outlet. Depending on the arrangement of the vent, **more than one drain may be required.** Unless a Drain Tee Cap is supplied with the appliance, install a Secure Seal Drain Tee Cap.
- More than one Category II, III or IV appliance may not be connected into the same vent system, unless the appliance manufacturer specifically approved such a system and the appliance are designed for multiple venting. Cat. II, III or IV appliances MAY NOT be common vented with Cat. I, natural draft appliances. This limitation can be removed if an engineering analysis demonstrates normal and safe operation of appliances.
- Secure Seal must not come in contact with plumbing or electrical systems.
- Maintain rated clearances to combustibles over the entire length of the vent system.
- Secure Seal shall not be routed into, through, or within any vent, such as an existing masonry or factory-built chimney, that is **connected to another appliance.**

# TYPICAL INSTALLATION

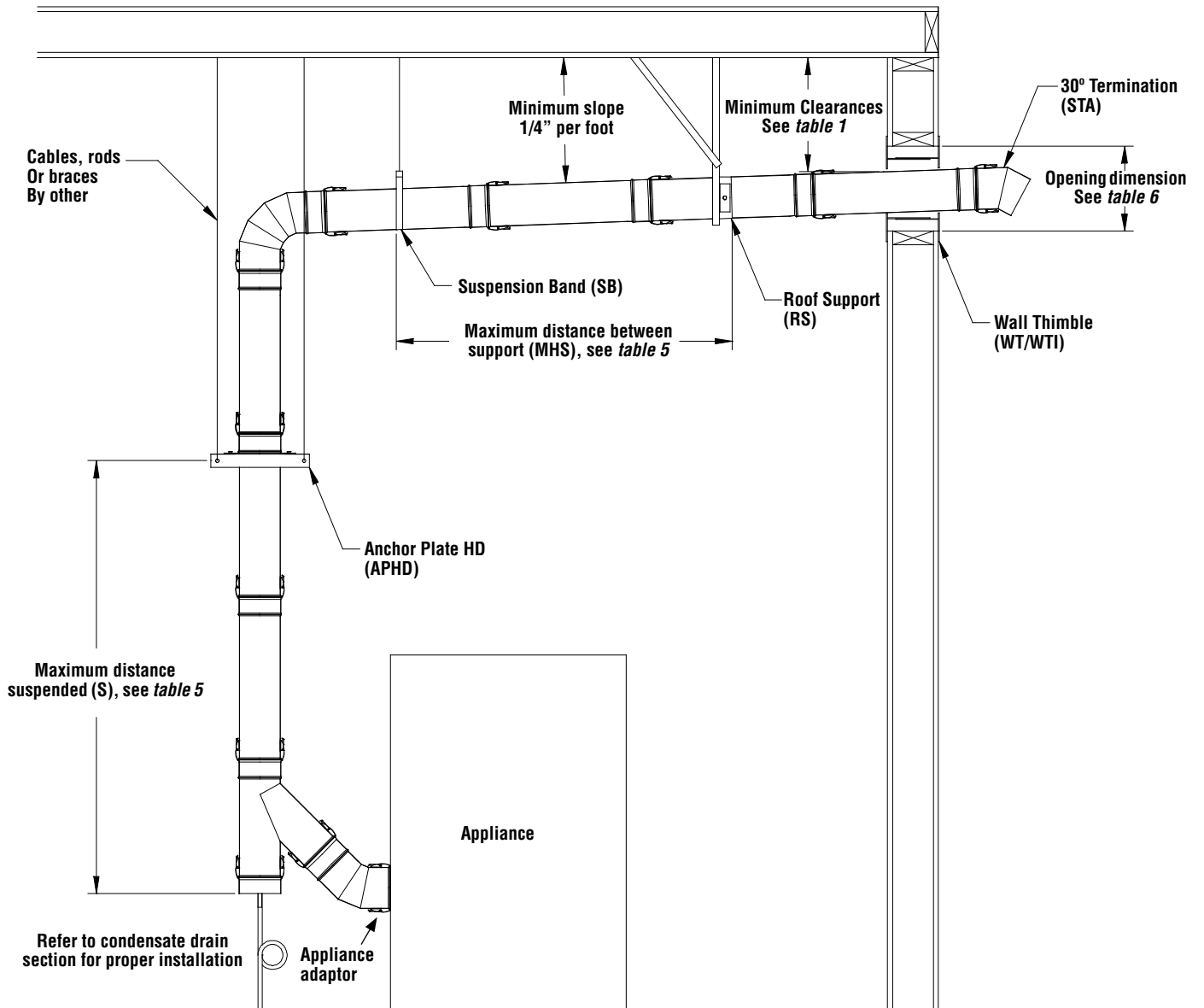
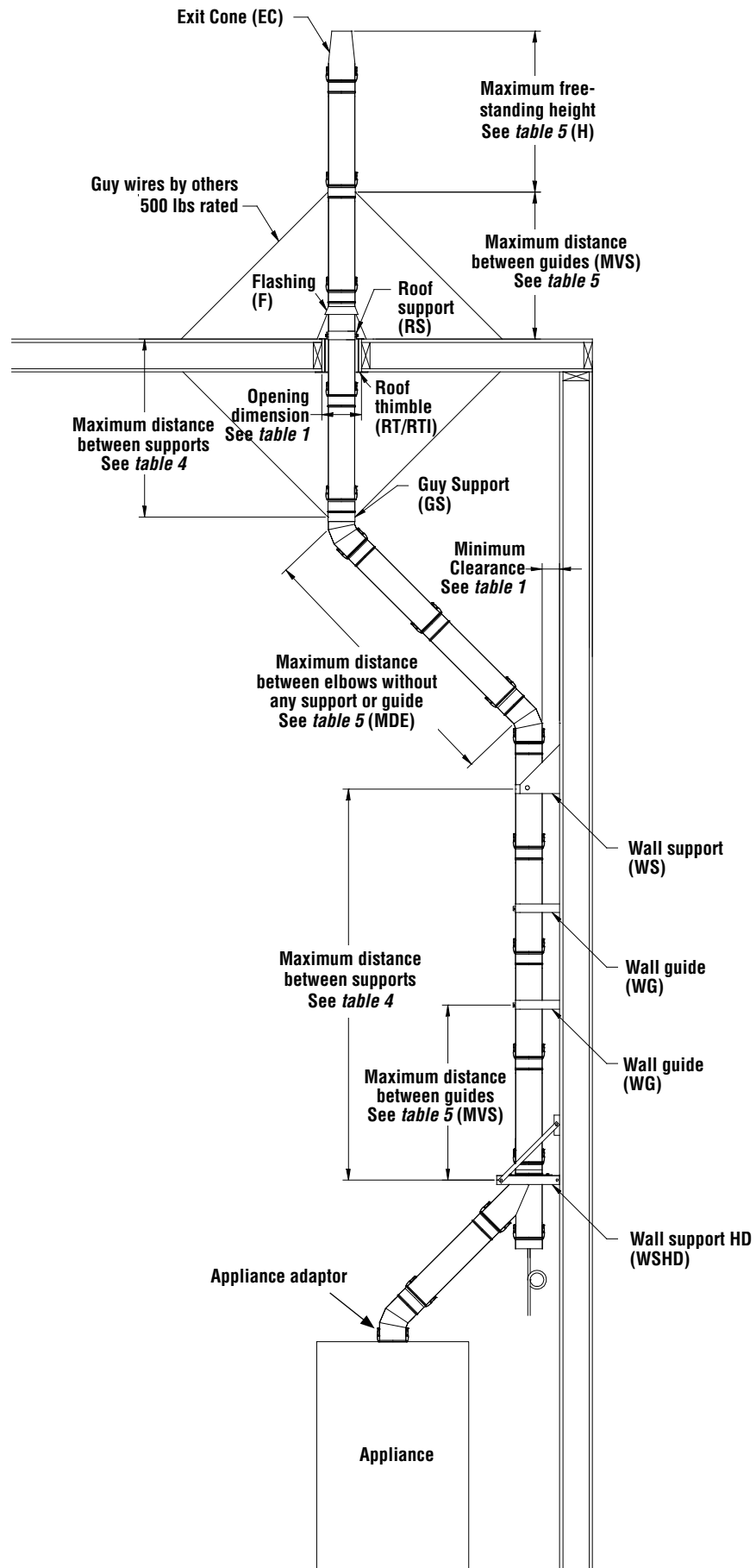

Figure 1 - Horizontal

**TYPICAL INSTALLATION**



**Figure 2 - Vertical**

NOTE: DIAGRAMS & ILLUSTRATIONS ARE NOT TO SCALE.

## CHIMNEY AND FITTING JOINT ASSEMBLY

All components have a male and female end, the male end has the gasket. The installation orientation is indicated on the labeling of each chimney section with an arrow. The arrow indicated the direction of the flow.

### Secure Seal® SS

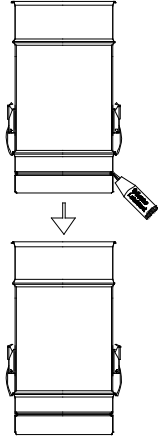

1. Add a thin film of silicone lubricant on the o-ring.

2. Insert the male end into the female end.

### Secure Seal SSD

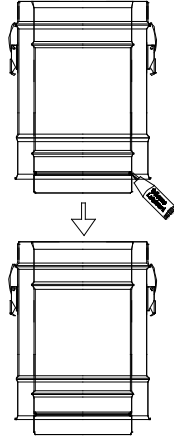

3. Close the clips to secure the joint.

**NOTE:**  
Clips are self-locking

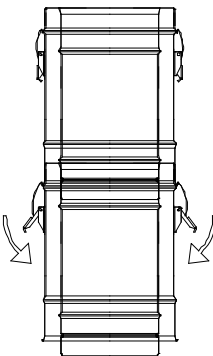
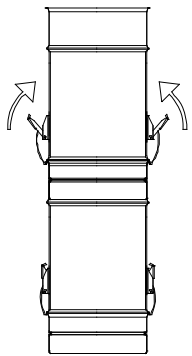

Figure 3 - Joint assembly steps

To open clips, push the secondary catch while pulling up the lever

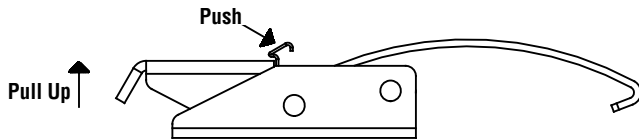

Figure 4 - Opening clips

## ASSEMBLY JOINT SS/SSD LUBE REQUIREMENT

Inside diameter	Qty (oz)
4"	0.1
5"	0.1
6"	0.1
7"	0.1
8"	0.2
9"	0.2
10"	0.2
12"	0.3
14"	0.3
16"	0.3
18"	0.4
20"	0.4
22"	0.5
24"	0.5

Table 2

## CHIMNEY WEIGHT

Chimney weight is given in pounds per foot of each diameter. It is important to know the weight of the chimney section for chimney support or guiding. Chimney weight (*table 3*) along with the maximum chimney height (*table 4*) is necessary to calculate the proper anchor strength needed with supports.

## CHIMNEY WEIGHT IN LB/FT

INSIDE DIAMETER	SS	SSD
4"	0.9	2.1
5"	1.1	2.6
6"	1.3	3.0
7"	1.5	3.4
8"	1.7	3.8
9"	1.9	4.3
10"	2.1	4.7
12"	2.6	6.2
14"	3.6	7.7
16"	4.1	8.7
18"	4.6	9.8
20"	5.1	10.8
22"	5.7	11.8
24"	6.2	12.8

Table 3 - Chimney weight

Example: Model Secure Seal SSD 6" diameter section of 25 feet in length from *table 3*, weight in lb/ft = 3. Total length 3 x 25 = 75lbs.

## SUPPORT METHODS AND HEIGHT

1. Several support and guiding methods are used to anchor a chimney against upward, downward and angular placement.
2. These supports and guides prevent bending stresses on the chimney elbows and joints.
3. Certain limitations apply for proper installation of supports and guides. See **tables 4 and 5**.
4. See **figure 1 and 2** for typical installations.

MAXIMUM CHIMNEY HEIGHTS AND SUPPORT METHOD FOR <b>MODEL SS</b>						
Inside dia.	Anchor Plate (AP)	Anchor Plate HD (APHD)	Wall Support (WS)	Wall Support HD (WSHD)	Roof support (RS)	Guy support (GS)
5"	195	195	97.5	195	97.5	225
6"	190	190	95	190	95	190
7"	185	185	92.5	185	92.5	160
8"	180	180	90	180	90	140
9"	175	175	87.5	175	87.5	130
10"	170	170	85	170	85	115
12"	160	160	80	160	80	90
14"	150	150	75	150	75	65
16"	140	140	70	140	70	60
18"	130	130	65	130	65	55
20"	120	120	60	120	60	50
22"	110	110	55	110	55	45
24"	100	100	50	100	50	40
MAXIMUM CHIMNEY HEIGHTS AND SUPPORT METHOD FOR <b>MODEL SSD</b>						
Inside dia.	Anchor Plate (AP)	Anchor Plate HD (APHD)	Wall Support (WS)	Wall Support HD (WSHD)	Roof support (RS)	Guy support (GS)
5"	97.5	97.5	48.75	97.5	48.75	95
6"	95	95	47.5	95	47.5	80
7"	92.5	92.5	46.25	92.5	46.25	70
8"	90	90	45	90	45	65
9"	87.5	87.5	43.75	87.5	43.75	55
10"	85	85	42.5	85	42.5	50
12"	80	80	40	80	40	40
14"	75	75	37.5	75	37.5	30
16"	70	70	35	70	35	27
18"	65	65	32.5	65	32.5	25
20"	60	60	30	60	30	22
22"	55	55	27.5	55	27.5	21
24"	50	50	25	50	25	20

**Table 4 - Dimensions are in feet**

SUPPORT AND GUIDE SPACING FOR <b>MODEL SS</b>						
Inside diameter	MVS		MHS	MDE	H	S
	Interior	Exterior				
4"	10	8	12	12	10	100
5"	10	8	12	12	10	100
6"	10	8	12	12	10	100
7"	10	8	12	12	10	100
8"	10	8	12	12	10	100
9"	10	8	12	12	10	100
10"	10	8	12	12	10	100
12"	10	8	12	12	10	100
14"	10	8	12	12	10	100
16"	10	8	12	12	10	100
18"	10	8	12	12	10	100
20"	10	8	12	12	10	100
22"	10	8	12	12	10	100
24"	10	8	12	12	10	100
SUPPORT AND GUIDE SPACING FOR <b>MODEL SSD</b>						
Inside diameter	MVS		MHS	MDE	H	S
	Interior	Exterior				
4"	10	8	12	12	10	50
5"	10	8	12	12	10	50
6"	10	8	12	12	10	50
7"	10	8	12	12	10	50
8"	10	8	12	12	10	50
9"	10	8	12	12	10	50
10"	10	8	12	12	10	50
12"	10	8	12	12	10	50
14"	10	8	12	12	10	50
16"	10	8	12	12	10	50
18"	10	8	12	12	10	50
20"	10	8	12	12	10	50
22"	10	8	12	12	10	50
24"	10	8	12	12	10	50

**Table 5 - Dimensions are in feet**

MVS : Maximum Vertical Spacing between Guides/Supports  
MHS: Maximum Horizontal Spacing between Guides/Supports  
MDE: Maximum Distance between Elbows  
H: Maximum Freestanding Height above the Roof  
S: Maximum Suspended Length

**\*Important Notes:**

1. For Anchor Plate (AP) / Anchor Plate Heavy Duty (APHD) / Wall Support Heavy Duty (WSHD), the support must be installed below a bead. See **figure 5**.
2. For Wall Support (WS) / Roof Support (RS) , the support can be installed anywhere on the part.

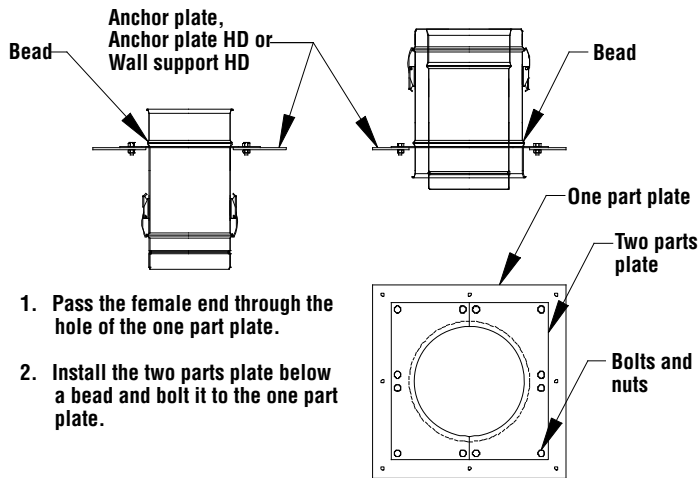

**Figure 5 - Position of support**

**HORIZONTAL INSTALLATION REQUIREMENTS**

- When venting through a sidewall, terminate the system not less than 12" (.3m) above the ground and above the snow line in geographical areas where snow accumulates. The termination area must be kept clear of snow and ice at all times.
- Terminate the system at least 7' (2.1m) above a public walkway or driveway, no less than 6' (1.8m) from the combustion air intake of any appliance or 3' (.9m) from any other building opening, gas utility meter, service regulator or the like. Less distance is permitted if specified in the appliance's installation instructions. It also shall terminate at least 3' (.9M) above any forced air inlet within 10' (3.1m) and shall terminate at least 4' (1.2m) below, 4' horizontally from, or 1' (.3m) above any door, window, or gravity air inlet into any building as provided in the National Fuel Gas Code ANSI Z223.1 and NFPA 54. See **figure 6**. Proper judgment may require greater distances depending on the side of the equipment installed or to allow for snow drifting or falling from overhead roofs or trees. The termination should be far enough away from trees, shrubs, or decorative items to prevent damage.
- The total horizontal vent length from the appliance flue collar to the outside termination shall be in accordance with the appliance manufacturer's instructions.

**MAINTAIN PROPER SLOPE**

- Install with a continuous 1/4" per foot (minimum) slope, as is required by the National Fuel Gas Code for all gas-fired appliances.
- Vent systems for condensing appliances must have a continuous 1/4" per foot (minimum) slope toward the appliance or a condensate drain. Always check the appliance manufacturer's instructions for proper drain requirements.
- Secure Seal<sup>®</sup> offers a range of tees and elbows that are built incorporating a 2 degree slope, we recommend that you use these to generate your slope.
- Some appliances require the venting system to be sloped toward the horizontal termination.
- Remember, if you raise the appliance or lower the ceiling you must adjust the slope of the vent to maintain the 1/4" per foot minimum.

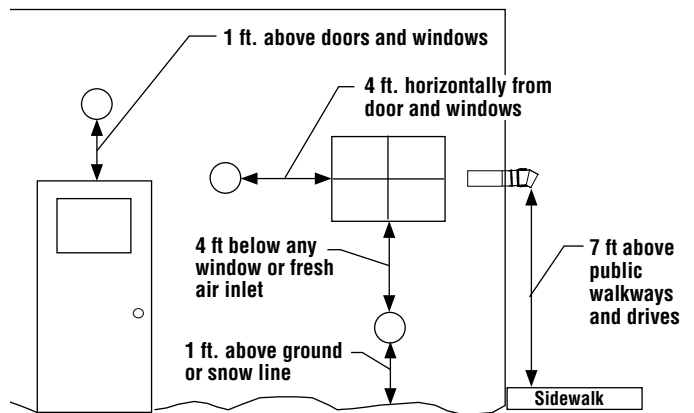

**Figure 6 - Horizontal termination requirements**

## VERTICAL INSTALLATION REQUIREMENTS

1. The vent system must terminate at least 3 feet above the roof line and at least 2 feet higher than any portion of the building within 10 feet. See **figure 7**. This limitation can be removed if an engineering analysis demonstrates normal and safe operation of appliance.
2. When terminated at a height of more than 10 feet, the stack must be supported by a Guy Section.
3. The vent system must terminate with one of the Secure Seal® terminations.

### Except;

- a) Category I appliances (natural draft) must use a Rain Cap. It is optional on Category II. This limitation can be removed if an engineering analysis demonstrates normal and safe operation of appliance.
  - b) Vent systems without provisions for draining rain water must use a Rain Cap.
  - c) Terminations or approved mechanical vent devices specified or provided by the appliance manufacturer are permitted.
4. The total continuous distance of the vent system from the appliance flue collar to the termination shall not exceed that specified in the appliance manufacturer's installation instructions. When venting natural draft appliances the termination must be at least 5 feet above the topmost draft hood. Otherwise a listed mechanical draft inducing device is required. This limitation can be removed if an engineering analysis demonstrates normal and safe operation of appliance.
  5. In general, systems installed in cold climates perform best, and condensation is reduced, when the system is fully enclosed by some part of the building structure.
  6. In cold climates do not install a condensate drain on the exterior of the building. Doing so may result in dangerous icy conditions on surfaces near the drain and may cause damage to the vent system and/or the building exterior. Security Chimneys will NOT be held liable for any personal injury or property damage due to any formation of ice.
  7. Vertical supports are required after every transition to vertical. Vertical supports are also required after every offset elbow.
  8. Unless Secure Seal is installed in a fire rated shaft, a roof thimble and support is required when penetration fire rated floors, walls or ceilings.

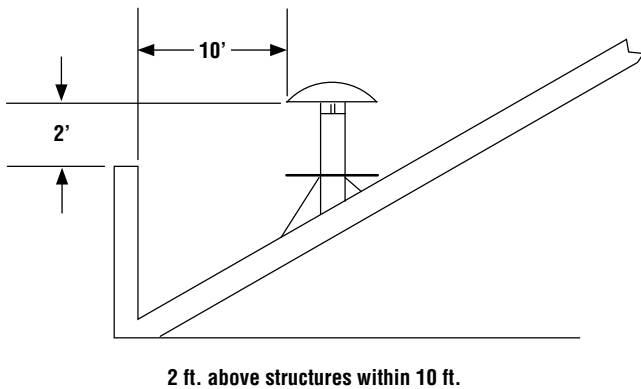

**Figure 7 - Vertical installation requirements**

## WALL PENETRATION

1. Prior to installation, determine proper location of wall thimble (WT) or wall thimble insulated (WTI) so that a minimum slope of 1/4" (6mm) per foot is maintained in the horizontal section of vent to ensure proper flow of condensation.
2. Prepare the wall by cutting a square opening. See **table 6** for opening dimension.
3. Install the wall thimble by inserting the larger of the two parts on the appliance (interior side). See **figure 8**.
4. Next, apply a bead of sealant around the edges of the exterior (smaller of the two parts) wall thimble component. Then install this part of the wall thimble by inserting the smaller collar into the other component from the previous step.

**NOTE: The two horizontal cylinders of the thimble must engage a minimum of two inches.**

5. Fasten both sides of the wall thimble using screws or nails.
6. Once the thimble is installed, Secure Seal vent pipe can be inserted into the thimble.
7. Close the gap between the thimble and the vent by installing the two half plate and fasten it using screws or nails.
8. Install horizontal termination to complete the assembly.
9. Once assembly is completed, apply a bead of high-temp sealant around the pipe and the exterior two half plates of the thimble to protect against weather.
10. The air gap is filled with insulation when using the insulated wall thimble (WTI).

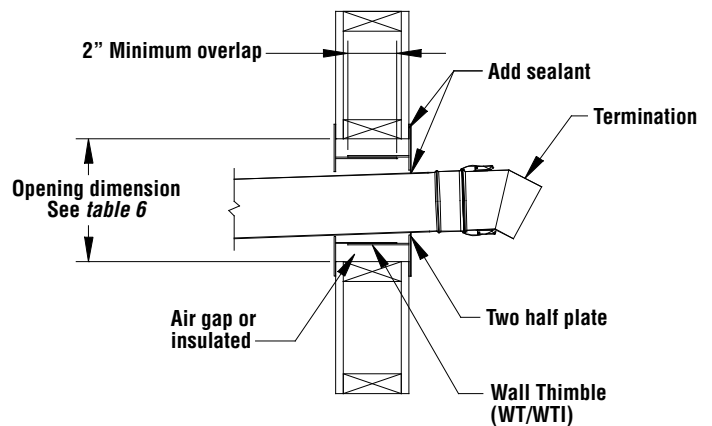

**Figure 8 - Wall penetration**

## ROOF / FLOOR PENETRATION

1. A roof thimble (RT) or roof thimble insulated (RTI) for cold climate must be installed every time the vent system passes through a floor or roof.
2. Prepare the roof / floor by cutting a square opening. See **table 6**.
3. Install the roof thimble. You may cut the radiation sleeve if it is too long. See **figure 9**.
4. For roof installation, install a flashing.

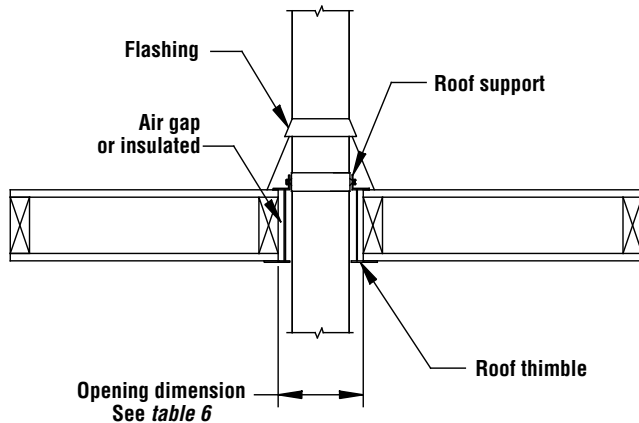

**Figure 9 - Roof penetration**

## CONDENSATE DRAINS

When an internal condensate drain is NOT part of the appliance:

1. A Drain length (DL) or a Tee with a drain tee cap (DTC) is strongly recommended. Install this drain as close as possible to the appliance flue collar.
2. A condensate drain is required for every 30 feet of horizontal vent and at the bottom of a vertical stack.
3. Use the Drain length for a straight horizontal run. Rotate the fitting so that the drain tube is as vertical as possible.
4. Use a Tee at a transition from horizontal to vertical, and attach the Drain Tee Cap to the appropriate branch of the tee.
5. A condensate drain tube kit is available to direct the condensate to an appropriate location. A trap loop must be formed into the drain hose and must be a diameter that is at least four times the appliance's rated stack pressure in inches of water column or minimum 3 inches. Secure the loop with a cable tie.
6. Flue gas condensate can have a low (3 to 5) PH level, follow all local and national codes and regulations for the draining of acidic condensate.
7. In cold climate, do not install a condensate drain on the exterior of the building. Doing so may result in dangerous icy conditions on surfaces near the drain and may cause damage to the vent system and the building exterior. Security Chimneys™ will NOT be held liable for any injury or property damage due to formation of ice.

### OPENING DIMENSIONS FOR WALL/ROOF PENETRATION FOR MODEL SS

Inside diameter	Wall Thimble (WT)	Wall Thimble Insulated (WTI)	Roof Thimble (RT)	Roof Thimble Insulated (RTI)
4"	9x9	10x10	8x8	12x12
5"	10x10	11x11	9x9	13x13
6"	11x11	12x12	10x10	14x14
7"	12x12	13x13	11x11	15x15
8"	13x13	14x14	12x12	16x16
9"	14x14	15x15	13x13	17x17
10"	15x15	16x16	14x14	18x18
12"	17x17	18x18	16x16	20x20
14"	22x22	22x22	22x22	22x22
16"	24x24	24x24	24x24	24x24
18"	26x26	26x26	26x26	26x26
20"	28x28	28x28	28x28	28x28
22"	30x30	30x30	30x30	30x30
24"	32x32	32x32	32x32	32x32

### OPENING DIMENSIONS FOR WALL/ROOF PENETRATION FOR MODEL SSD

Inside diameter	Wall Thimble (WT)	Wall Thimble Insulated (WTI)	Roof Thimble (RT)	Roof Thimble Insulated (RTI)
4"	11x11	12x12	8x8	12x12
5"	12x12	13x13	9x9	13x13
6"	13x13	14x14	10x10	14x14
7"	14x14	15x15	11x11	15x15
8"	15x15	16x16	12x12	16x16
9"	16x16	17x17	13x13	17x17
10"	17x17	18x18	14x14	18x18
12"	19x19	20x20	16x16	20x20
14"	22x22	22x22	18x18	22x22
16"	24x24	24x24	20x20	24x24
18"	26x26	26x26	22x22	26x26
20"	28x28	28x28	24x24	28x28
22"	30x30	30x30	26x26	30x30
24"	32x32	32x32	28x28	32x32

**Table 6 - Dimensions are in inches**

**INSTALLING SECURE SEAL® AS A LINER IN A MASONRY CHIMNEY OR AS A LINER IN AN EXISTING VENT**

\* Stainless Steel Wire Rope (by others) is to be used to hang the vent system from the top of the masonry chimney or from the top of the existing vent.

- The stainless wire rope is attached to the Guy Support Band and is secured with cable clamps (by others).
- The Stainless Steel Wire Rope is secured in a similar manner to the top platform of the masonry chimney or existing vent.
- Use the appropriate size of Stainless Steel Wire Rope to accommodate the required total loads of the vent system.

It may be necessary to fabricate a platform (at top of chimney / vent - by others).

Consult Security Chimneys International for guidelines.

**DO NOT USE GALVANIZED WIRE ROPE.**

Note: When installed as a liner in a masonry chimney or to reline an existing vent no other appliance can be vented into the same chimney or vent.

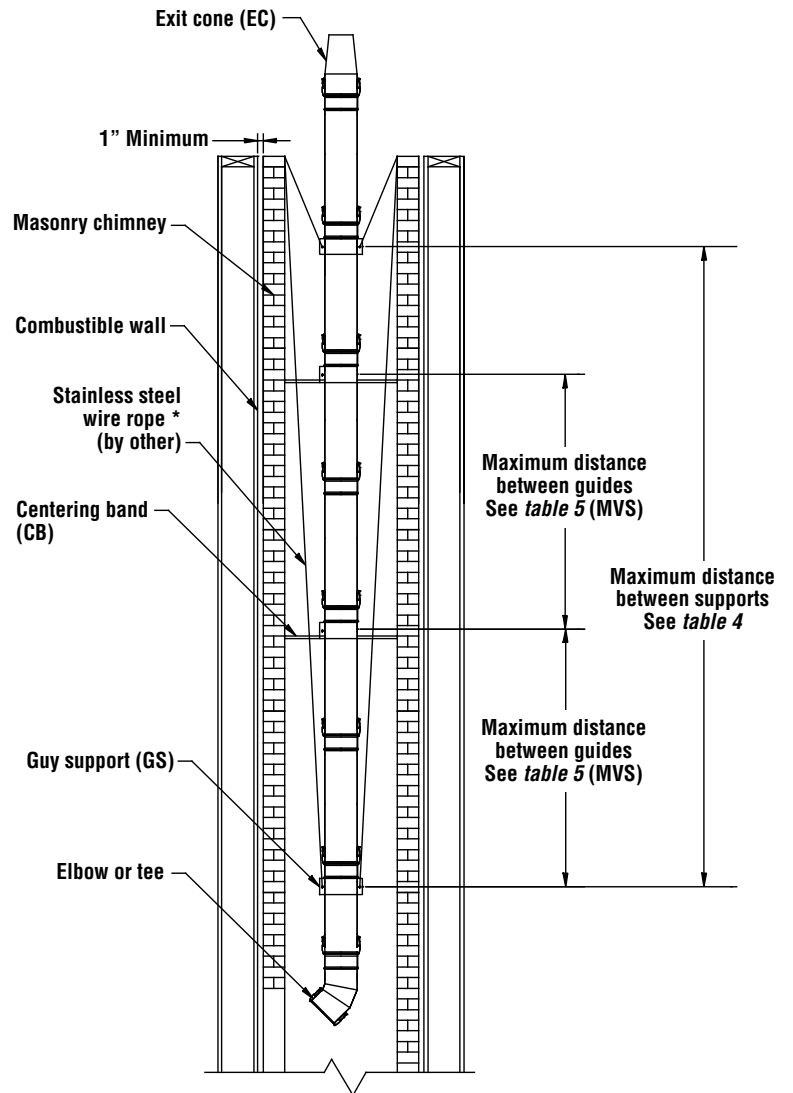

**Figure 10 - Installing Secure Seal as a liner**

## ADJUSTABLE LENGTH

For installations that requires non-standard vent lengths, Secure Seal<sup>®</sup> Adjustable Length (AL) should be used.

**Note:** *The inner conduit may be cut to desired length to limit interference with downstream part.*

## MAINTENANCE INSTRUCTIONS

As with all vents, the Secure Seal vent system should be inspected at least annually for the presence of deposits or debris and any accumulation should be removed. The vent system should also be inspected at regular periods for signs of leakage of condensate or combustion products at any joints.

If the vent system incorporates a drain hose from either a Drain length or a Drain tee cap, the hose must be inspected periodically to ensure that water is in the trap loop. If a proper trap loop is not maintained, exhaust from the connected appliances may accumulate in the building area.



## WARRANTY

This product has a 15 year limited warranty. Please read the warranty to be familiar with its coverage.

Retain this manual. File it with your other documents for future reference.

## PRODUCT REFERENCE INFORMATION

Please contact Security Chimneys International for the phone number of your nearest Security Chimneys International dealer who will answer your questions or address your concerns.

Normally, all parts should be ordered through your Security Chimneys International distributor or dealer. Parts will be shipped at prevailing prices at time of order.

When ordering repair parts, always give the following information:

1. The model number of the vent system.
2. The part number.
3. The description of the part.
4. The quantity required.
5. The installation date of the chimney system.

If you encounter any problems or have any questions concerning the installation or application of this system, please contact your dealer.

Lennox® and Security Chimneys International Limited reserves the right to make changes at any time, without notice, in design, materials, specifications, prices. Consult your local distributor for chimney system code information.

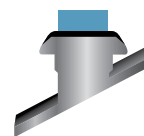

**SECURITY CHIMNEYS  
INTERNATIONAL™**